

Omnipod

Generation 2

Instructions and Set Up

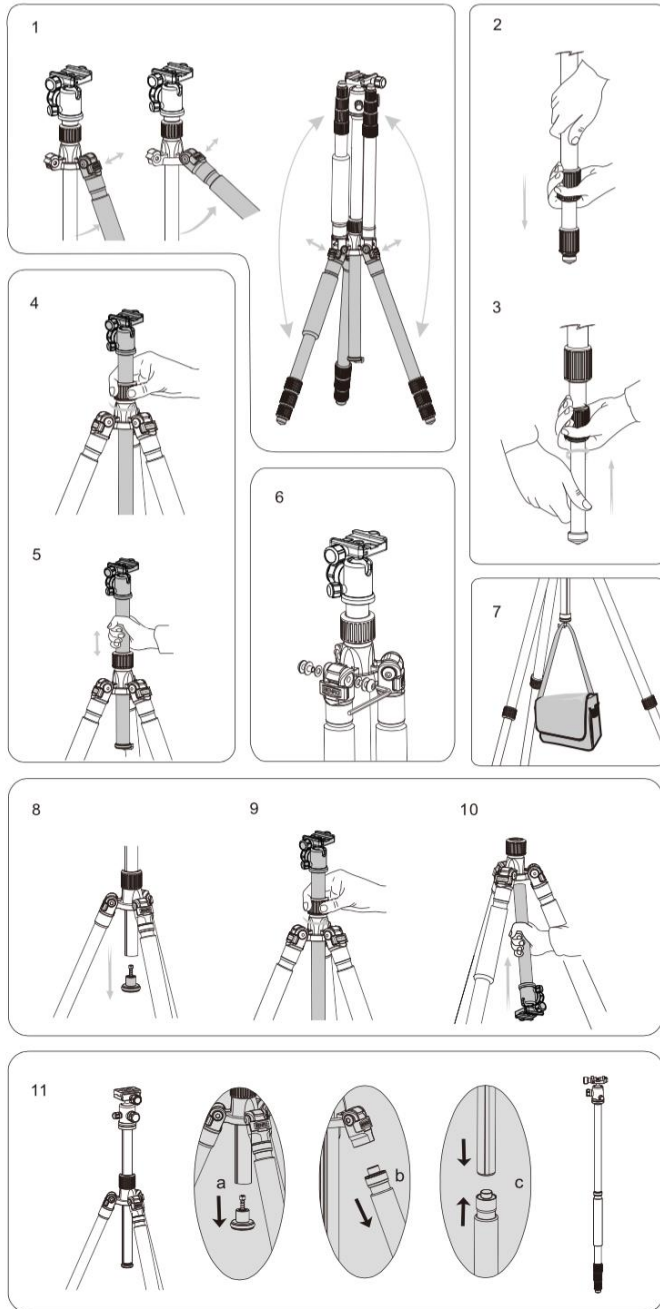

Leg Adjustment: (See figure 1)

For accommodating uneven terrain, awkward shooting situations or low angle shooting, Omnipod includes a 4-position leg angle adjustment secured by a push/pull lock. Make sure that each leg lock is pushed down to secure the standard frame position or wide frame position. To compact the rig again, pull up each leg lock then fold them back into their original positions as seen in #1. Be sure all leg sections are collapsed and secured as well (see below).

Expanding the Legs: (See figures 2 & 3)

Each of the 4 sections of the leg can be adjusted to a specific length by turning any rotary knob counter-clockwise until the leg freely slides. Once a desired length is achieved, turn the rotary knob clockwise until the leg is fully secured. Repeat this step for each leg until Omnipod reaches a comfortable height for the operator. Keep in mind the rig reaches 6 feet (1829 MM) with the center column fully extended.

Adjusting the Center Column: (See figures 4 & 5)

To raise or lower the center column, turn the center rotary knob counter-clockwise and set the column to any position. While holding the column in this position, turn the rotary knob clockwise to secure it in place.

Tightening/Loosening Legs: (See figure 6)

You can adjust the smoothness of the legs using the included hex Allen tools found in the side pocket of the bag.

Retractable Weight Hook: (See figure 7)

For larger cameras or windy conditions, we recommend adding additional weight to stabilize Omnipod. You can do this by adding weight to any bag (we recommend using the standard one that Omnipod comes in) and attaching it to the retractable weight hook at the bottom of the center column.

Reversible Center Column: (See figures 8, 9 & 10)

Omnipod has the ability to reverse the center column for macro photography shots. To do this, unscrew the retractable weight hook that's at the bottom of the center column, then loosen the center column rotary knob and pull the center column out. Insert the center column with the head pointing upside down and retighten the

center column rotary knob securely. The center column has an anti-twist groove, so please be sure to line-up the groove with the key before reversing the column.

Tripod to Monopod: (See figure 11, 12 & 13)

- Unscrew the retractable weight hook from the bottom of the center column, then take the center column assembly (with the head) out.
- Unscrew the tripod leg with a rotary screw near the head.
- Screw and assemble the center column assembly (with head) onto the tripod leg. A monopod is now converted from the original rig. Store the remaining system in the padded bag until ready to assemble again.

Securing your Mounts: (See figures 14-19)

Be sure to choose the right mount for your Camera. Omnipod comes standard with 3 different arca-type quick release mounts. After securing your camera to the respected mount, place it on top of Omnipod's aluminum head (see figure 14+15) then secure it in place by tightening the knob directly beside it (see figure 16+17).

Panning and 360° Horizontal Scale (See figure 19)

Omnipod has a 360° lock ballhead and rotating scale. Twist the 3 marked knobs counterclockwise to loosen the tension of the ballhead until a desired setting is found. From there, rotate the knobs clockwise to secure the tension.